

# MACTECH

# PGM-HD

PORTABLE GANTRY MILL - HEAVY DUTY

[MACTECHONSITE.COM](http://MACTECHONSITE.COM)

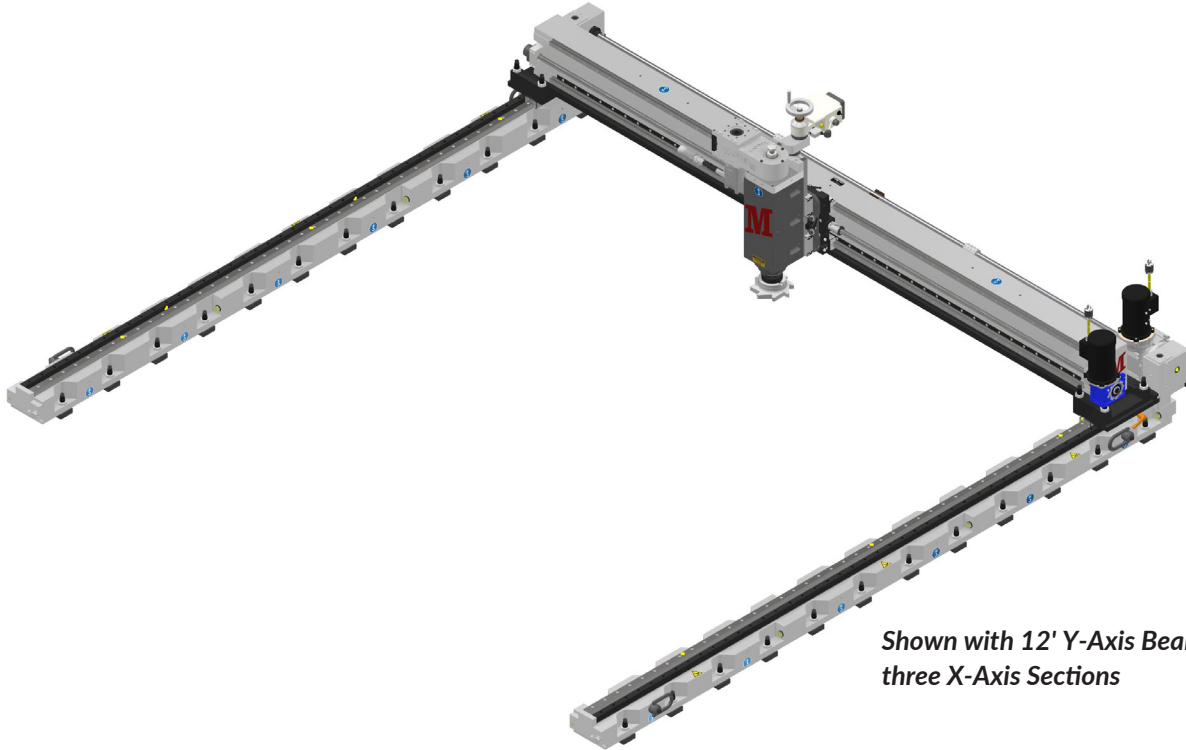

*Shown with 12' Y-Axis Beam and three X-Axis Sections*

## PRODUCT DESCRIPTION

Save costly shop repairs with accurate, on-site milling, drilling and machining with an expandable X-axis reach. Adding or removing sections provides versatility to meet the demands of multiple varied setups. A powerful hydraulic drive motor makes smooth, clean and efficient cuts.

Mactech offers a fast response with the best technicians and support, short delivery times, high accuracy, and custom setups make Mactech's Portable Gantry Mill - Heavy Duty among the most versatile of on-site milling machines for your job.

## FEATURES

- MODULAR DESIGN ALLOWS FOR X-AXIS TO BE INCREASED IN 4' SECTIONS, AND Y-AXIS AVAILABLE IN 6', 9' AND 12'
- ADJUSTABLE JACKING SCREWS AND SUPPORT PLATES MAKE SETUP QUICK AND EASY
- LINEAR RAILS, PRECISION BALL SCREWS AND RIGID SETUP ENSURE ACCURATE MACHINING
- EASY TO USE: REMOTE X AND Y-AXIS MOTOR CONTROLS
- OPTIONAL Z-AXIS POWER FEED

**MACTECH INC.**  
4079 PEPIN AVE UNIT 4  
RED WING MN 55066  
800-328-1488  
[INFO@MACTECHONSITE.COM](mailto:INFO@MACTECHONSITE.COM)

**MACTECH OFFSHORE**  
302 IDA ROAD  
BROUSSARD LA 70518  
337-839-2793  
[INFO@MACTECHOFFSHORE.COM](mailto:INFO@MACTECHOFFSHORE.COM)

**MACTECH KENTUCKY**  
3880 INDUSTRIAL DRIVE  
PADUCAH KY 42001  
270-442-1559  
[INFO@MACTECHONSITE.COM](mailto:INFO@MACTECHONSITE.COM)

**MACTECH WISCONSIN**  
2515 CLEVELAND AVE  
MARINETTE WI 54143  
800-328-1488  
[INFO@MACTECHONSITE.COM](mailto:INFO@MACTECHONSITE.COM)

**MACTECH INTERNATIONAL**  
CONTACT US FROM ANYWHERE  
AROUND THE WORLD  
+1 651-388-7117  
[INFO@MACTECHOFFSHORE.COM](mailto:INFO@MACTECHOFFSHORE.COM)

WORK HARD

WORK SAFE

WE BEFORE ME

WELCOME CHALLENGES

WOW THEM

## SPECIFICATIONS

### X-AXIS:

Electric Feed Motor: 120V Input, 1/2 HP  
Gear Reduction: 40:1  
Feed Rate: 0 to 24.0 inches/minute

### Y-AXIS:

Electric Feed Motor: 120V Input, 1/2 HP  
Gear Reduction: 40:1  
Feed Rate: 0 to 20.0 inches/minute

### Z-AXIS:

#50 NMTB Taper Shaft Spindle  
Optional Electric Power Feed

### SPINDLE MOTOR:

Hydraulic: 4.9 or 6.2ci, 800 RPM, 20 GPM

Electric: 110V or 220V Variable Speed

*Electric drives may not be suitable for all tasks, please contact Mactech representative for advisement.*

PGM - HD		Dimension (Width)	Travel	Machining Range	Cantilevered Reach	Weights
Y-Axis Beam(s)	6' Beam	78"/1981	43"/1092	55.5"/1409	37.5"/952	1884lb/854kg
	9' Beam	114"/2895	79"/2006	91.5"/2324	73.5"/1867	2233lb/1012kg
	12' Beam	146"/3708	115"/2921	127.5"/3238	109.5"/2781	2582lb/1171kg
		Dimension (Length)				
X-Axis Rail (Single)		47.75"/1213	30.75 /831	43.25"/1098	N/A	213lb/96kg (per)
X-Axis Rail (Each Additional)		47.75"/1213	47.75"/1213	47.75"/1213	N/A	213lb/96kg (per)
		Dimension (Height)				
Z-Axis		35"/889	8.6"/218	N/A	N/A	301lb/136kg

Dimensions shown: in/mm

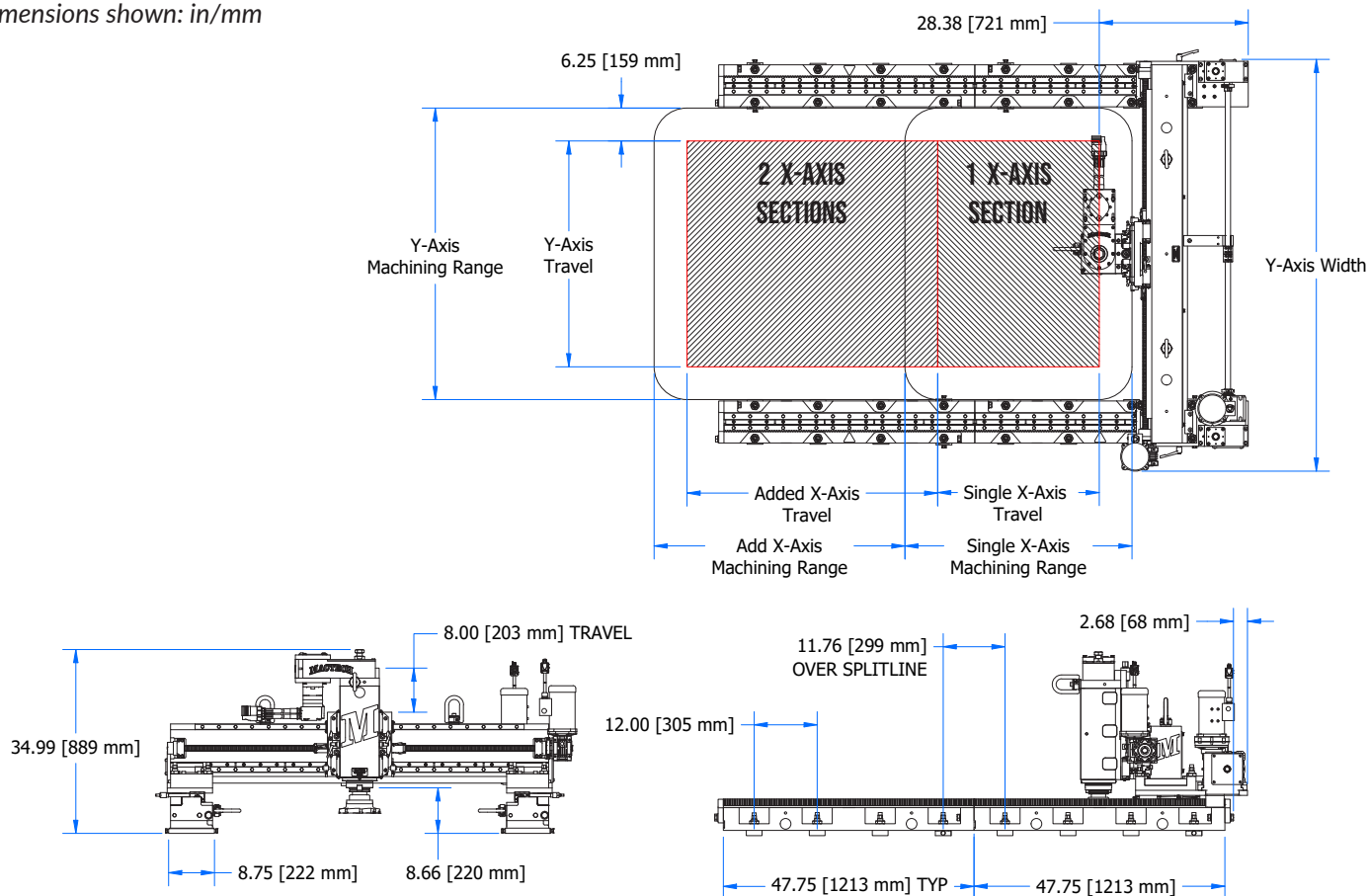

## CANTILEVER EXAMPLE

More variations possible depending on setup

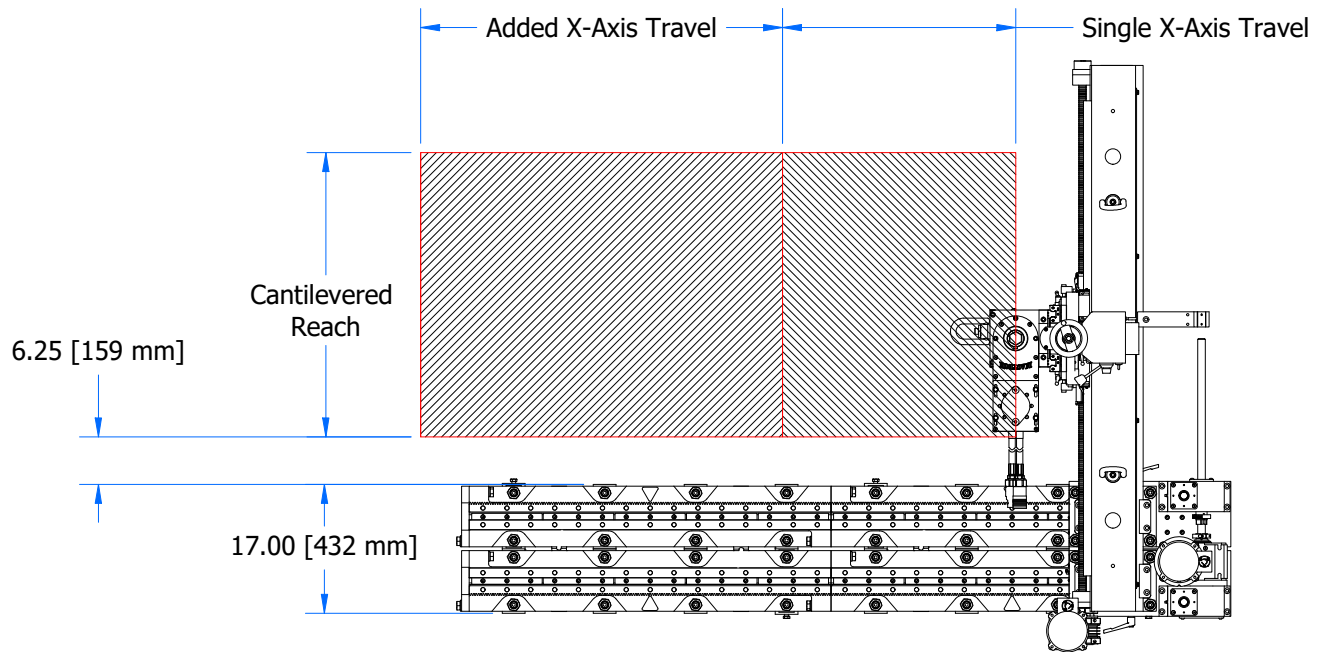

## MILL HEAD ROTATION EXAMPLES

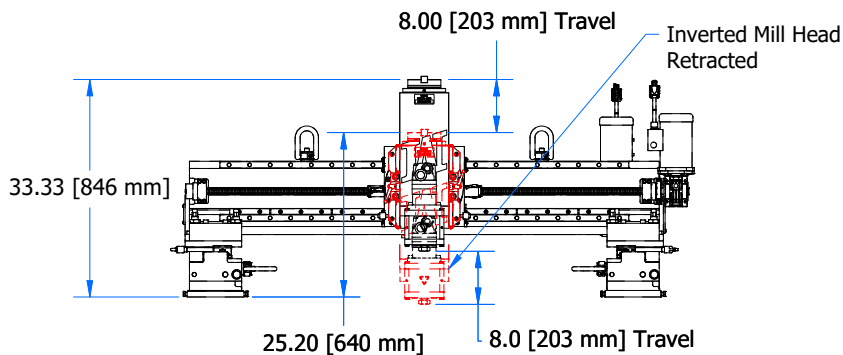

**MILL HEAD INVERTED**

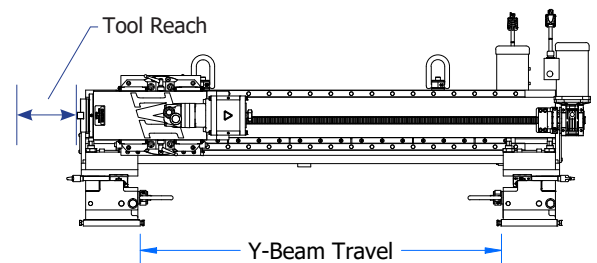

**MILL HEAD HORIZONTAL**

All dimensions and hydraulic requirements are for reference and may be subject to change without notice. Machine performance is subject to application and operator capability; please discuss your requirements directly with a Mactech sales representative. All information given and all sales made by Mactech Inc. are subject to their terms and conditions.

## X-AXIS STARTER KIT (REQUIRED)

**605-7055**

Contains: PGM-HD - 96" X-Axis Drive Kit W/Cat 50 Spindle & 8" Z-Axis (Four 4' X-Axis rail sections), PGM-HD Tool Kit, Adjustable Weld-On Brackets (2), Setup and Operation Manual, Drawing Package, Shipping Crate

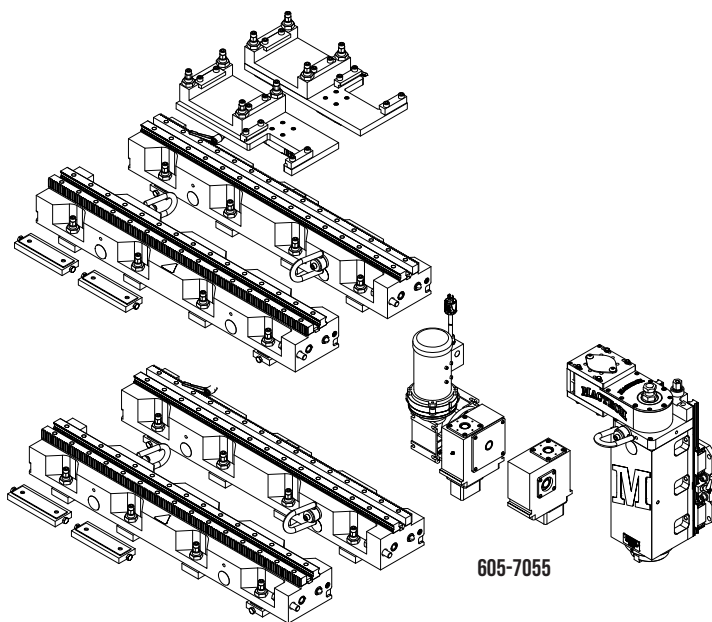

605-7055

## Y-AXIS BEAM PACKAGE OPTIONS (CHOOSE ONE)

Includes Z-Axis Mounting Plate, Rotary Drive Shaft, Electric Drive Assy. 120vac Input, Shipping Crate

**605-7056**

PGM-HD 12' - Y/Z-Axis Beam Package

**605-7057**

PGM-HD 9' - Y/Z-Axis Beam Package

**605-7058**

PGM-HD 6' - Y/Z-Axis Beam Package

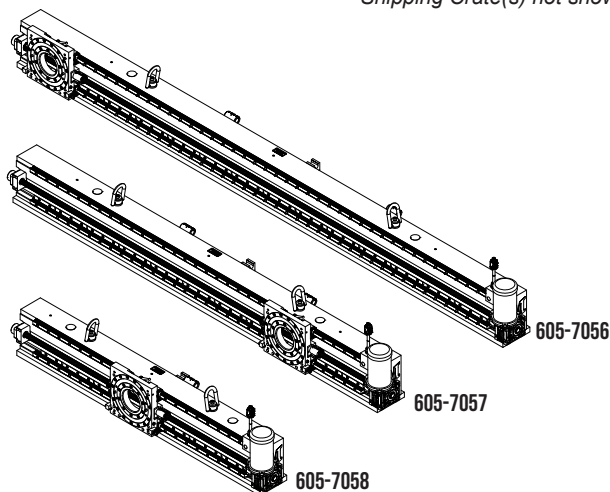

605-7056

605-7057

605-7058

Shipping Crate(s) not shown

## X-AXIS EXTENSION SECTIONS

Each Extension kit adds 48" of travel  
Includes two 4' sections and Shipping Crate

**605-7054**

PGM-HD Rail – 4' X-Axis Extension Kit

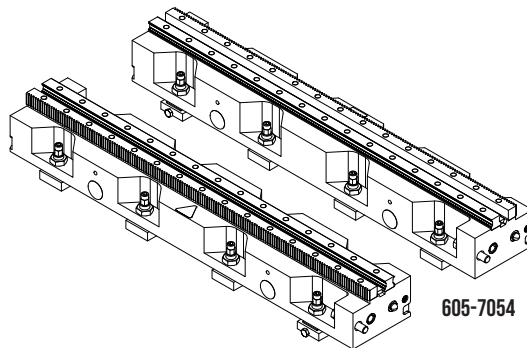

605-7054

Shipping Crate not shown

All dimensions and hydraulic requirements are for reference and may be subject to change without notice. Machine performance is subject to application and operator capability; please discuss your requirements directly with a Mactech sales representative. All information given and all sales made by Mactech Inc. are subject to their terms and conditions.

## SPINDLE MOTOR OPTIONS (CHOOSE ONE)

### HYDRAULIC MOTOR OPTIONS

- |                 |   |
|-----------------|---|
| <b>600-6981</b> | Hyd Drive - 4.9ci, 90-900 RPM, 2-20 GPM<br>Recommended Up to 5" Face Mill |
| <b>600-7058</b> | Hyd Drive - 6.2ci, 60-740 RPM, 2-20GPM<br>Recommended for 5-8" Face Mills |

### ELECTRIC MOTOR OPTIONS

*Electric drives may not be suitable for all tasks, please contact Mactech representative for advisement.*

- |                 |  |
|-----------------|--|
| <b>600-6655</b> | 2200w, 0-570RPM Variable, 4 Speed,<br>Reversible, 220V |
| <b>600-6657</b> | 2200w, 0-570RPM Variable, 4 Speed,<br>Reversible, 110V |

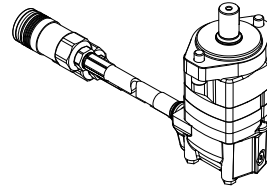

600-6981 / 600-7058

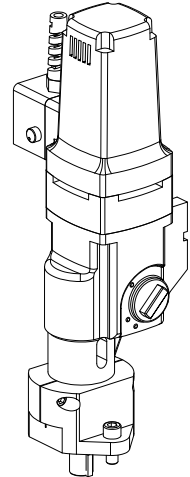

600-6655 / 600-6657

## Z-AXIS SERVO MOTOR (OPTIONAL)

### Power Feed Option

- |                 |                                 |
|-----------------|---------------------------------|
| <b>600-6983</b> | Servo Feed Drive – Mgm 2:1 110V |
|-----------------|---------------------------------|

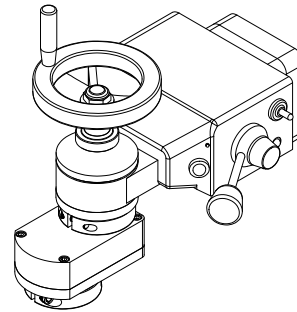

600-6983

## CUTTER AND FACE MILL OPTIONS

Kits come with the holder, the cutter, 10 inserts, 5 spare screws, and insert tool.

- |                 |  |
|-----------------|--|
| <b>445-1119</b> | 5" 12 Flt 45° Face Mill With Cat50<br>Assembly |
| <b>445-1122</b> | 6" 10 Flt 45° Face Mill With Cat50<br>Assembly |
| <b>445-1120</b> | 8" 12 Flt 45° Face Mill With Cat50<br>Assembly |

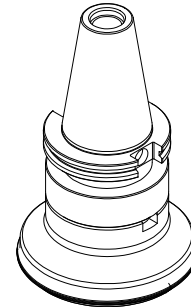

445-1119

## TOOLING AND INSERT OPTIONS

### Available Cutters, Face Mills, and Tool Holders

- |                 |  |
|-----------------|--|
| <b>445-2013</b> | Face Mill Insert SEET13T33AGSR-L<br>ACP100 Light Cutting Steel   |
| <b>445-2014</b> | Face Mill Insert SEMT13T33AGSR-G<br>ACP200 General Purpose Steel |
| <b>445-2019</b> | Face Mill Insert SEET13T33AGFR-L H1<br>Aluminum                  |



445-2014

*Other material bits have  
same form factor*

All dimensions and hydraulic requirements are for reference and may be subject to change without notice. Machine performance is subject to application and operator capability; please discuss your requirements directly with a Mactech sales representative. All information given and all sales made by Mactech Inc. are subject to their terms and conditions.

## HYDRAULIC POWER SUPPLY OPTION

Includes: HYD Hoses, 3/4" X 50', 3/4" ISO 16028 Flat Face Quick Disconnects

**128-0278-50** HPS, 20HP 480V, 16 GPM @ 1500

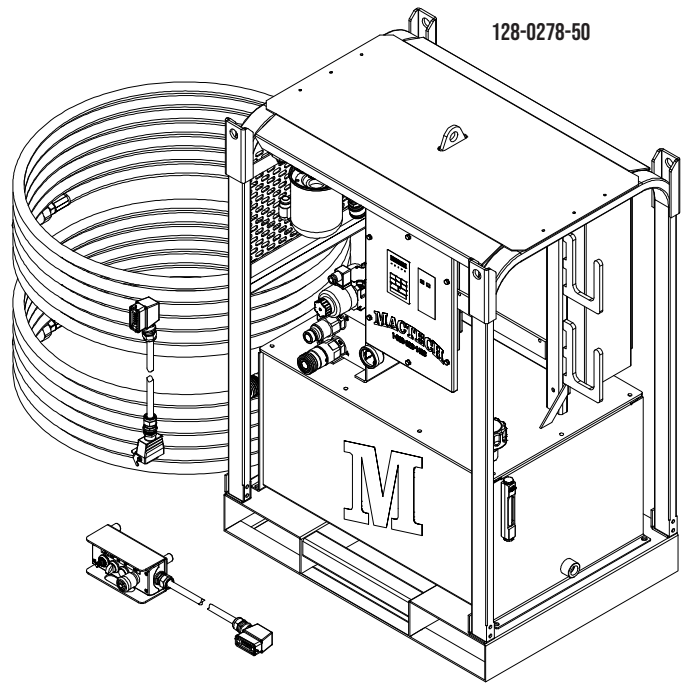

## HAND TOOL KIT (INCLUDED IN X-AXIS STARTER KIT)

Includes: Tool Box, Combination Wrenches, 13pc Long Arm Allen Set, T-Handle Allen Key, 3/8" Ratchet Drive Set, Dead Blow Hammer, Aligning Pry Bar

**600-6969-TK** PGM-HD Tool Kit

## CONSUMABLE ITEMS

- 621-1107** Weld-On Mill Mtg Bracket - Mgm
- 600-7048** X Adjustable Weld On Bracket Assy - Mgm
- 452-0838** Chip Guard - Flexible-Arm, 12 X 12, 12" Magnet Arm
- 600-6969-SP** PGM-HD Spares Kit

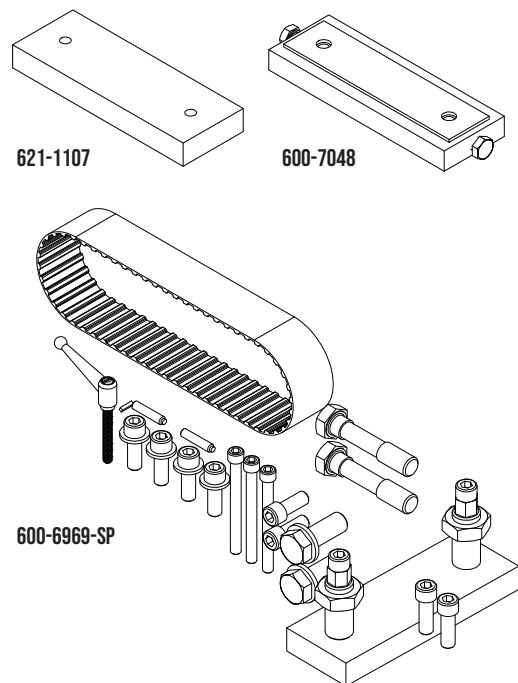

All dimensions and hydraulic requirements are for reference and may be subject to change without notice. Machine performance is subject to application and operator capability; please discuss your requirements directly with a Mactech sales representative. All information given and all sales made by Mactech Inc. are subject to their terms and conditions.